



Portola Packaging Ltd

UK Product Specification

EL30 Carton Fitment



PRODUCT DESCRIPTION

The EL30 “fitment” style closure is a two piece injection moulded closure consisting of spout and cap. The fitment is intended to be ultrasonically welded to a paper board gable top container. The primary seal is established by the membrane within the spout. A secondary seal is established where the top of the spout meets the valve inside the cap. The membrane acts as the tamper evidence. The design intent is that the cap be removed by unscrewing it first followed by the membrane to break the seal. The EL30 features Cap retention features to ensure effective overcap fit.

Product Code: 420. Part Weight 3.2g±0.25g

Material: Overcap HDPE, Spout LDPE

DIMENSIONS

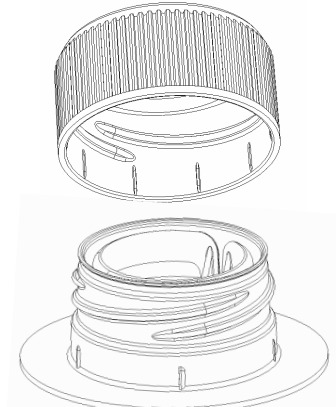
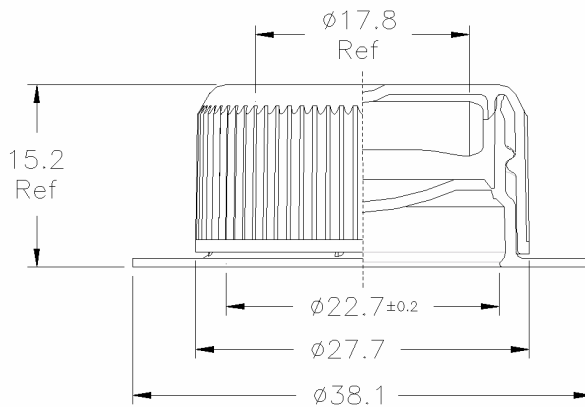

PACKING METHOD

- Approx. 2800 caps per bag. 1 bag per box
- 35 boxes per pallet. 98,000 caps per pallet.
- Corrugated carton – Board grade 186T2/175SC/190T3
- Returnable Packaging Alternative, 46,000 caps per Pallecon, 1000 caps per pack
- Carton Identification – Each filled carton will display the name of manufacturer, date of manufacture, mould identification, product identification code and name, base and spout colour, average Qty. and box number.
- Pallet Identification – Date, product identification code and name, Pallet number, Qty.

PALLET DETAILS

- Width 1000mm
 - Length 1200mm
 - Height 2250mm
- Including Pallet

MATERIALS

All materials used in the process including additives and masterbatches are fully approved for direct food contact and meet the requirements of all relevant EU directives and the FDA (Food and Drug Administration). This applies to the Base cap, Spout and Dust cover.

RECOMMENDED STORAGE CONDITIONS	
<ul style="list-style-type: none"> • In a dry, dust free environment. • Production shall be rotated on a “first in first out” basis. The product should be used within 6 months of the date of manufacture and a further 90 days post application to the bottle/product. • Product should not be stored where it is subject to water damage or exposure to chemicals or odour. • Keep the Cartons closed and bags knotted at all times until immediately prior to use. • Avoid double stacking which will cause damage to Packaging or Product within. • Recommend that Cartons be stacked one pallet high only. • Avoid temperature extremities keep away from temperatures below 5°C and above 30°C. • It is further recommended that the caps are stored in temperatures between 10°C and 30°C 24 hours prior to use. 	
SUITABILITY TESTING	HANDLING
<ul style="list-style-type: none"> • Taint and Odour - to test for tainting of the product. 	<ul style="list-style-type: none"> • If fed to hopper/sorter to be via belt convey or with flights used ensure there are no trap points as to cause damage. • Sorter to ensure smooth feed with no trap points to cause jam-ups or damage to closures. • Chute to be constructed to ensure closures feed freely without being able to jam.
ASTHETICS	
<ul style="list-style-type: none"> • Colours - Available in a wide variety of Portola standard colours. • Custom colours also available based on volume 	
IMPORTANT NOTE	
<p>While the supplier (Portola Packaging) take every precaution and use both their experience and that of their suppliers in the selection of materials and processing of the product, it is deemed ultimately the responsibility of the client to confirm and maintain tests which assure compatibility with the product and mating items. In respect of but not limited to integrity of product, security of package, taint and smell.</p> <p>It is the customer’s responsibility to ensure local regulations are met, as the supplier has no way of knowing the areas or countries the product will be sold or marketed in.</p> <p>The supplier’s responsibility shall be restricted to notification of proposed changes in conditions or materials, which may require secondary testing and customer approval.</p>	