



Portola Packaging Ltd Product Specification

ELC30 Carton Fitment



PRODUCT DESCRIPTION

The ELC30 closure is a two piece injection moulded closure consisting of spout and cap, the fitment is designed to be ultrasonically welded to a paper board gable top container. The primary seal is established by the Bore Seal feature within the cap. The Tamper evidence is facilitated by an external tamper band retained onto the spout.

Product Code: 426. Part Weight 2.65 \pm 0.25g

DIMENSIONS

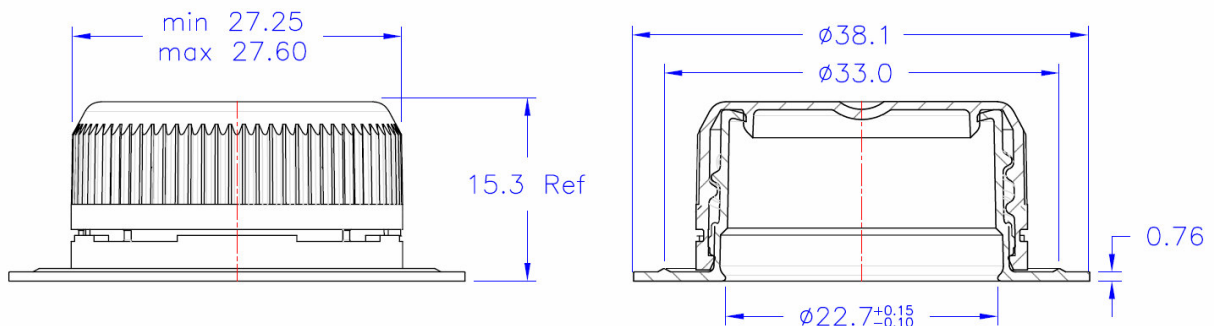

PACKING METHOD

- Approx. 3000 caps per bag. 1 bag per box
- 35 boxes per pallet. 105,000 caps per pallet.
- Corrugated carton – Board grade 186T2/175SC/190T3
- Returnable Packaging Alternative, 46,000 caps per Pallecon, 1000 caps per pack
- Carton Identification – Each filled carton will display the name of manufacturer, date of manufacture, mould identification, product identification code and name, base and spout colour, average Qty. and box number.
- Pallet Identification – Date, product identification code and name, Pallet number, Qty.

PALLET DETAILS

- Width 1000mm
 - Length 1200mm
 - Height 2200mm
- Including Pallet

MATERIALS

All materials used in the process including additives and masterbatches are fully approved for direct food contact and meet the requirements of all relevant EU directives and the FDA (Food and Drug Administration). This applies to the Cap & Spout

RECOMMENDED STORAGE CONDITIONS	
<ul style="list-style-type: none"> • In a dry dust free environment.. • Product should not be stored where it is subject to water damage or exposure to chemicals or odour. • Keep the cartons closed and taped and bags knotted at all times until immediately prior to use, if less than a full carton is to be used, the bag containing the remaining closures should be retied and the top flaps of the carton secured to prevent contamination. • Product should be stored in temperatures between 10°C and 30°C for 24 hours prior to use. • Storage Temperature 5-30°C • Maximum storage period prior to application: 6 months from date of manufacture • Minimum storage temperature after application 3°C • Maximum storage temperature after application 25°C • Maximum palletized limit; 2 high with layer pad. • Product to be stored in low UV conditions out of direct sunlight. • Maximum recommended time on container, 12 months. 	
SUITABILITY TESTING	HANDLING
<ul style="list-style-type: none"> • Taint and Odour - to test for tainting of the product. 	<ul style="list-style-type: none"> • If fed to hopper/sorter to be via belt convey or with flights used ensure there are no trap points as to cause damage. • Sorter to ensure smooth feed with no trap points to cause jam-ups or damage to closures. • Chute to be constructed to ensure closures feed freely without being able to jam.
ASTHETICS	
<ul style="list-style-type: none"> • Colours - Available in a wide variety of Portola standard colours. • Custom colours also available based on volume 	
IMPORTANT NOTE	
<p>While the supplier (Portola Packaging) take every precaution and use both their experience and that of their suppliers in the selection of materials and processing of the product, it is deemed ultimately the responsibility of the client to confirm and maintain tests which assure compatibility with the product and mating items. In respect of but not limited to integrity of product, security of package, taint and smell.</p> <p>It is the customer's responsibility to ensure local regulations are met, as the supplier has no way of knowing the areas or countries the product will be sold or marketed in.</p> <p>The supplier's responsibility shall be restricted to notification of proposed changes in conditions or materials, which may require secondary testing and customer approval.</p>	